

TYPICAL CROSS SECTION OF PAVING  
SCALE 1:20

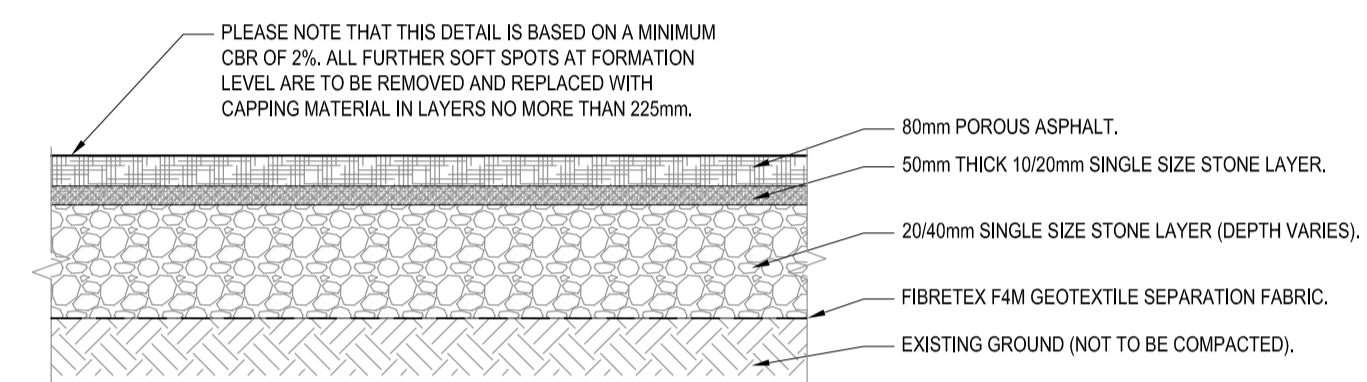

TYPICAL CROSS SECTION OF POROUS ASPHALT SURFACE  
SCALE 1:20

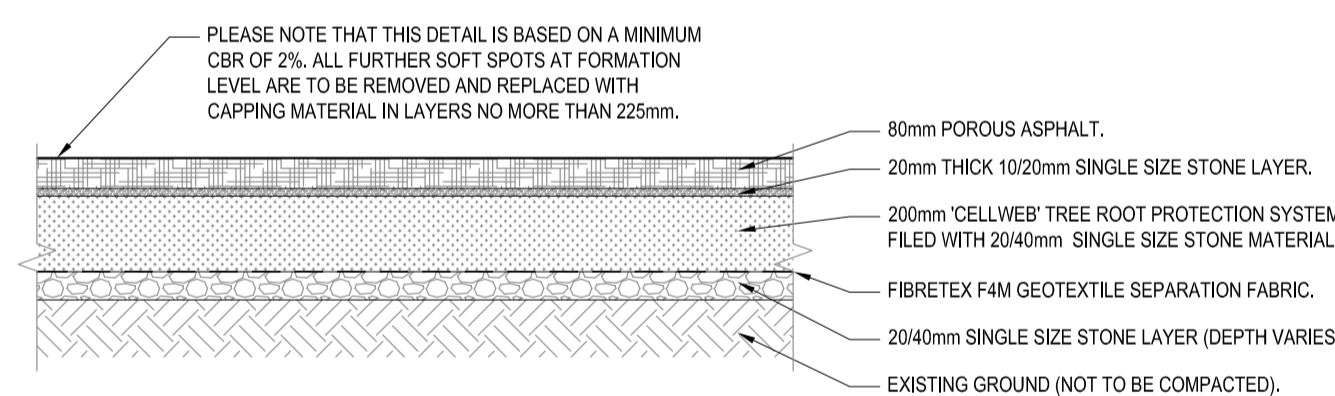

TYPICAL CROSS SECTION OF TREE ROOT PROTECTION ZONE  
SCALE 1:20

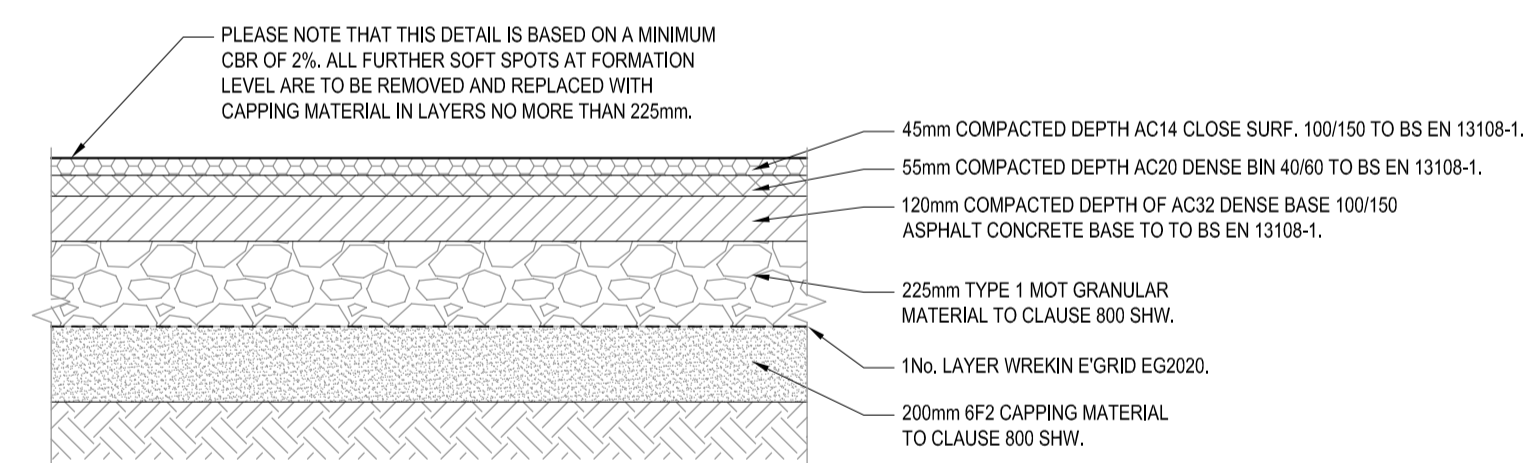

TYPICAL CROSS SECTION OF ASPHALT SURFACE  
SCALE 1:20

- NOTES:**
- ALL DIMENSIONS ARE IN MILLIMETERS (mm) UNLESS NOTED OTHERWISE.
  - STRUCTURAL DESIGN & REINFORCEMENT DETAIL TO BE PROVIDED BY THE DEVELOPER AND SUBMITTED TO IRISH WATER FOR REVIEW.
  - ALL CONCRETE TO BE IN ACCORDANCE WITH IS EN 206.
  - PRECAST KERBS TO BE IN ACCORDANCE WITH IS EN 1340:2003.
  - ALL LEVELS ARE IN METERS AND RELATE TO THE ORDNANCE SURVEY DATUM.
  - VERIFY EXISTING LEVELS PRIOR TO COMMENCEMENT OF WORKS. REPORT ANY DISCREPANCIES IMMEDIATELY TO THE ENGINEER.
  - THE LOCATION OF EXISTING SERVICES IN INDICATIVE ONLY. IT IS THE RESPONSIBILITY OF THE CONTRACTOR TO DETERMINE THE EXISTENCE, PRECISE LOCATION AND DEPTH OF ANY SERVICE OR ADDITIONAL SERVICES NOT SHOWN WITHIN THE SITE.
  - EXISTING TREES ARE TO BE PROTECTED FROM SITE TRAFFIC AND HEAVY MACHINERY. GROUND IN ROOT PROTECTION ZONES OF EXISTING TREES IS NOT TO BE COMPACTED BY SITE TRAFFIC.
  - ALL ITEMS OUTLINED ON THIS DRAWING TO BE READ IN CONJUNCTION WITH THE SPECIFICATION AND BILL OF QUANTITIES.

- PAVEMENT:**
- TRANSVERSE JOINTS BETWEEN NEW & EXISTING PAVEMENTS TO BE CONSTRUCTED IN ACCORDANCE WITH NRA RCD/700/3. LONGITUDINAL JOINTS BETWEEN NEW & EXISTING PAVEMENTS TO BE CONSTRUCTED IN ACCORDANCE WITH NRA RCD/700/4.
  - THE REQUIREMENTS FOR EACH PAVEMENT TYPE TO BE IN ACCORDANCE WITH THE SPECIFICATION AND AS DESCRIBED HEREUNDER.
  - ASSUMED CBR OF EXISTING GROUND >3%. CONTRACTOR TO CHECK GROUND CONDITIONS BEFORE COMMENCING WORKS.
  - GROUND UNDER THE PROPOSED CELLWEB SYSTEM IS NOT TO BE COMPACTED, TO ALLOW WATER PERCOLATION.
  - CELLWEB SYSTEM TO BE INSTALLED TO MANUFACTURER SPECIFICATION AND METHODOLOGY. MANUFACTURER REPRESENTATIVE IS TO SUPERVISE THE INSTALLATION PROCESS.
  - CELLWEB TO BE FILLED WITH CLEAN 20/40mm (40% Voids MINIMUM) SINGLE SIZED STONE MATERIAL IN ACCORDANCE WITH IS EN 13242 AND TII PUBLICATION DOCUMENT CO-SPW-00500 "SPECIFICATION FOR ROAD WORKS SERIES 500 DRAINAGE".
  - PROVIDE FOR A PA 14 SURF PMB 65/105-70 POROUS ASPHALT IN ACCORDANCE WITH CLAUSE 6.0 OF TII PUBLICATION DOCUMENT CO-SPW-00900 "SPECIFICATION FOR ROAD WORKS - ROAD PAVEMENT BITUMINOUS MATERIAL".
  - POROUS ASPHALT TO BE TESTED TO ENSURE REQUIRED VOID CONTENT IS ACHIEVED TO ALLOW SURFACE WATER PERCOLATION IN ACCORDANCE WITH CLAUSE 6.0 OF TII PUBLICATION CO-SPW-00900 "SPECIFICATION FOR ROAD WORKS - ROAD PAVEMENT BITUMINOUS MATERIAL".

| Rev | Date     | Description           | By | Chk | App |
|-----|----------|-----------------------|----|-----|-----|
| 00  | 16/05/22 | ISSUE FOR INFORMATION | LT | RT  | AG  |

**BYRNE LOOBY**  
WWW.BYRNELOOBY.COM  
IRELAND | UK | UAE | BAHRAIN | KSA

CLIENT  
GEDV MONKSTOWN OWNER LIMITED

PROJECT  
RESIDENTIAL DEVELOPMENT ON LANDS OF DALGUISE HOUSE

DRAWING TITLE  
TYPICAL ROAD & PAVING DETAILS

STATUS  
FOR INFORMATION

|                   |                        |           |         |         |
|-------------------|------------------------|-----------|---------|---------|
| Date: 16/05/22    | Scale: AS SHOWN        | Drawn: LT | Chk: RT | App: AG |
| Project No: W3683 | Dwg. No: W3683-DR-1019 | Rev:      |         | 00      |